

P&W R985 PROPELLER INSTALLATION INSTRUCTIONS

COUNTERWEIGHT PROP

For constant speed counterweight prop
In a smooth bore crankshaft, remove
Plug 264399 and seal 44076 as shown in
Figure 1.

For constant speed counterweight prop
In a hydromatic crankshaft as shown in
Figure 2 or 3, remove plug 39579 and
Gasket 743 as shown in figure 4.



Figure 1

HYDROMATIC PROP

Remove the following parts as shown in
Figure 4:

Plug 39579 (Shipping only)

Gasket 743 (Shipping only)

Lockplate 39576 (Production Type)

Lockplate 47705 (Re-Operated Type)

Nut 39575 (Production Type) 1 3/4"

Nut 40355 (Re-Operated Type) 1 15/16"

Cone Plug 39574

Ensure that gasket 39578 is in good
Condition and install distributor valve. If
The shaft is re-operated as shown in
Figure 2, sleeve 73914 must be installed.

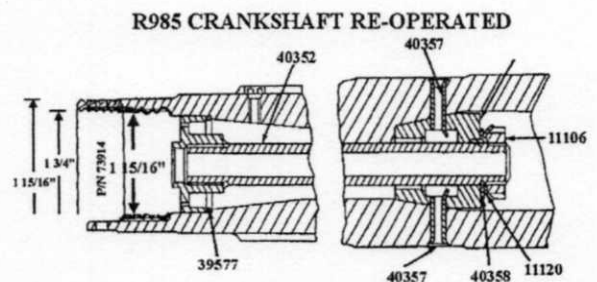

Figure 2

R985 CRANKSHAFT - PRODUCTION TYPE

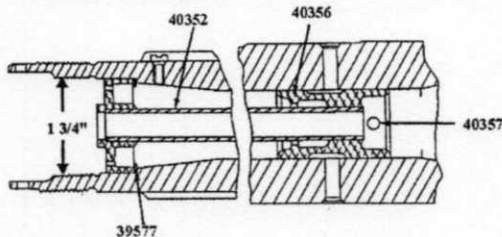

Figure 3

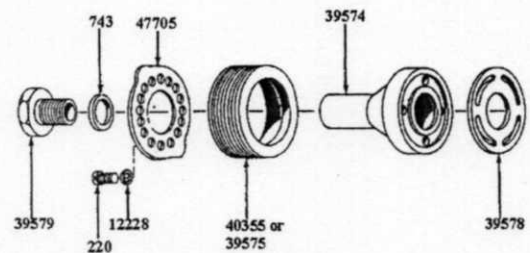

Figure 4